

Thank you for choosing Cunningham as your *Clever Protective Cover* specialists

### Step 1

- Fix panel in position with temporary fixings
- e.g. large screw

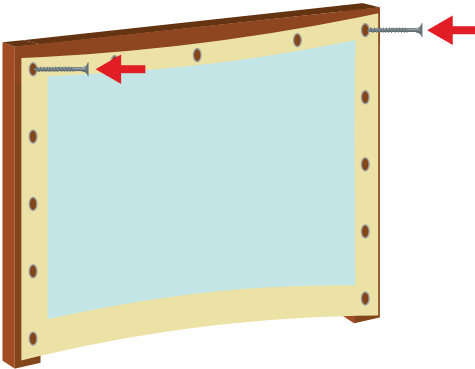

### Step 2

- Mark out positions where turnbuttons will be fixed

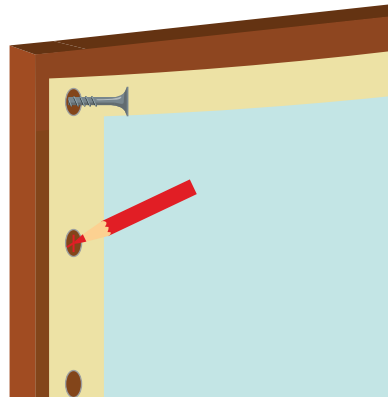

### Step 3

- Remove panel and secure fixings in line with markings.
- Start with middle & corner eyelets as a guide, check panel is in correct position before proceeding with remainder of fixings.

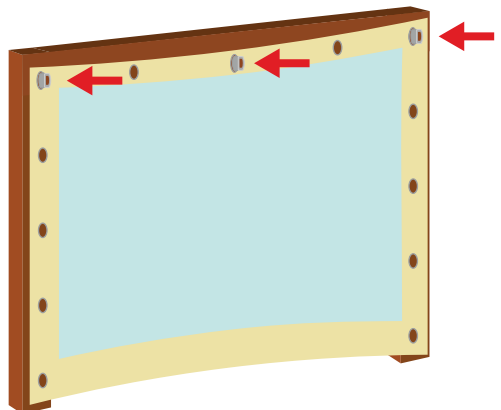
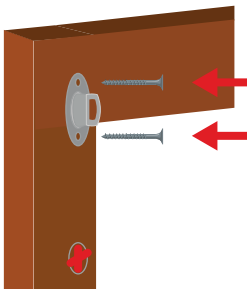

## Step 4

- Place eyelet over turn-button and turn to secure in place

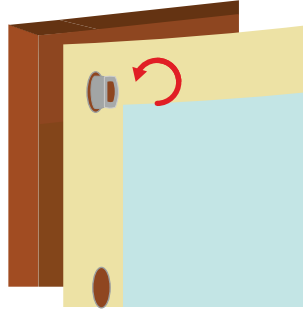
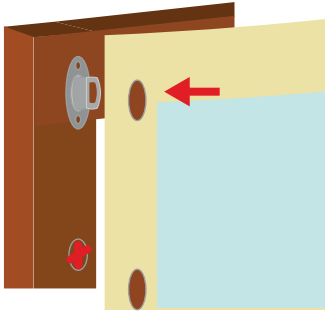

### Initial Installation

We recommend your panels are kept rolled down for the first couple of weeks after installation. This allows the product to settle and straighten through its own weight.

### General Maintenance

Windows can be cleaned with warm soapy water and a cloth/sponge. A power washer may also be used as long its from a distance of at least 1.5m.

### Winter Maintenance

Keep the panels rolled down during winter, especially in temperatures below 5C. Keeping panels rolled up during colder temperatures can cause them damage.

### Warnings

Sharp objects can scratch or otherwise damage the panels. Panels that come in contact with extreme heat e.g. fire, sparks or cigarettes can cause damage.

### Strong Winds

In strong winds, ensure the panels are rolled down and securely fastened.

### Rolling Up

When rolling your panels up, make sure they are completely dry and clean.

### Roll Down at Night

Your panels should be rolled down every night to prevent shrinkage and discolouration from condensation.

Scan the QR code for our  
YouTube Panel Fitting Video



Send a snap of your cover to  
[info@cunninghamcovers.co.uk](mailto:info@cunninghamcovers.co.uk)

Thank you!

